

DC
colonnes®



Bespoke decorative columns and pillars that fit your project

DC-colonnes has developed a unique system of modular columns and pillars in cast aluminium that are cut to size to fit your needs. These columns are both decorative and structural. Initially developed for outdoor usages (conservatories, gazebos, orangeries, verandas, terraces...), these columns can also be used for indoor projects (lofts, decoration and restorations, pubs, mezzanines, etc.)

These columns are modular because all elements (capitals, bases, shafts, decorative elements) can be chosen independently from each other. Several hundreds of combinations are possible.



Conservatories or verandas are places to live in the whole year round, places where you can benefit from each season. They are openings towards the surrounding nature. But they are also safe investments, a real added value to your house. So, while you are at it, do not hesitate to add the small "touch of class" detail that will make it a truly unique creation. Columns or pillars will transform your project into a place of elegance.

Decorative columns, grooved or smooth, create spaces that are inviting and open on the outside, and constitute pleasant transitions between the nature and your interior. They represent welcoming elements, and stimulate the design of new architectural components that modulate the original shape of your building.

Columns and pillars open vistas and spaces, they give rhythm to the volumes, and another dimension to the playing of the light. They will add style and originality to your building at no excessive cost.



Our columns and pillars are in cast aluminium: once lacquered, no one can see a difference with casted steel. They can also be used for the evacuation of rain waters.

Architects and designers are welcome to download DWG and DXF drawings of all the components of our system from our website www.dc-colonnes.com.

These columns and pillars are entirely produced in our aluminium foundry in Belgium. We have more than 50 years of experience in the casting of aluminium and other light metals.

Jean-Louis Coussement



Ref 01 - Champs-Elysées - Ø80



Ref 02 - Orléans - Ø80



Ref 03 - Longchamp - Ø80



Ref 04 - Versailles - Ø80



Ref 05 - Pont-Aven - Ø100

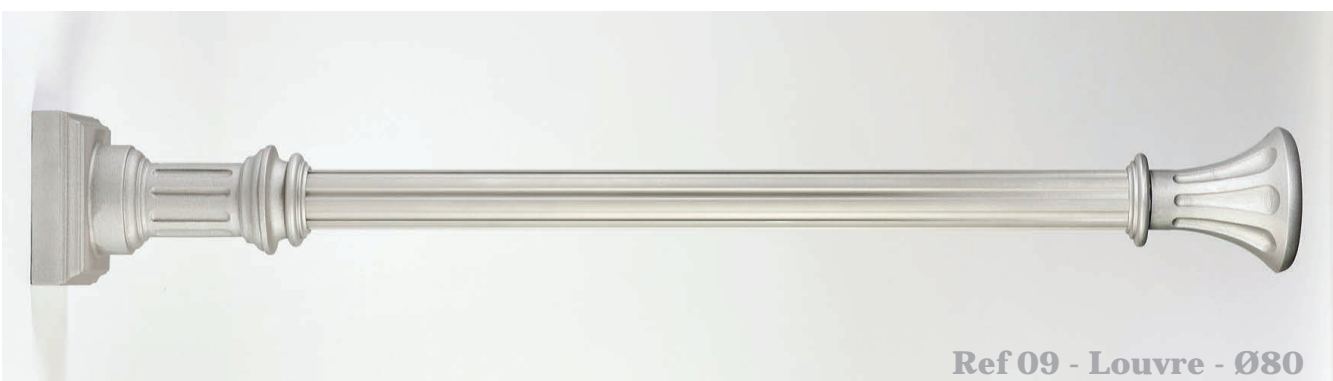



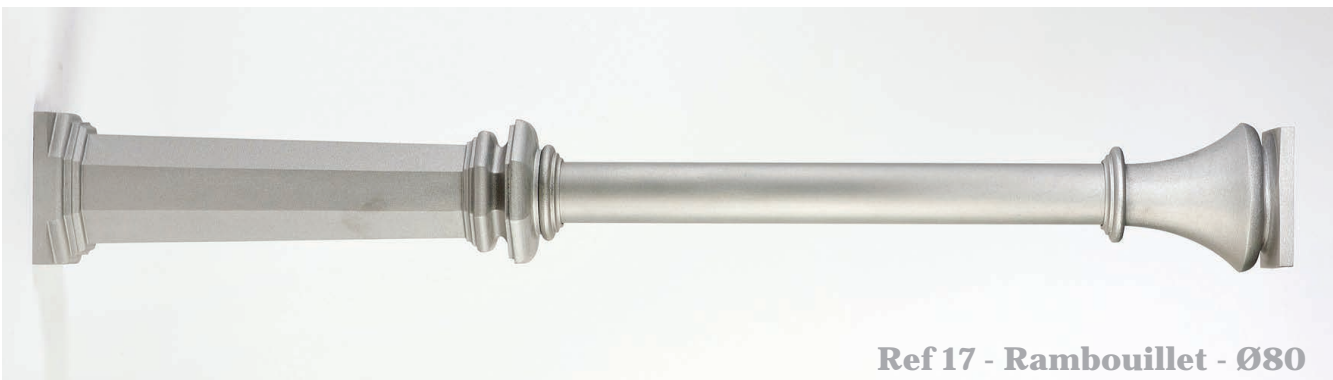







Ref 31 - Oléron - Ø100



Ref 33 - Roscoff - Ø100



Ref 34 - Carnac - Ø100



Ref 35 - George V - Ø80

DC products - Configurations



Shaft type '1'

ref. length 200cm* : 60 P1-2000
 ref. length 250cm* : 60 P1-2500
 ref. length 300cm* : 60 P1-3000

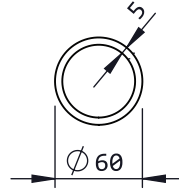

*Other sizes available on request

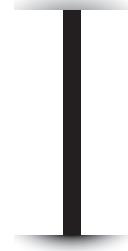

Temple Rosace

ref. : 60 TEMP A



Weight : 2,8 kg
 Structural element

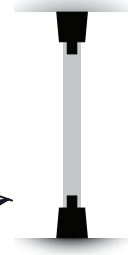
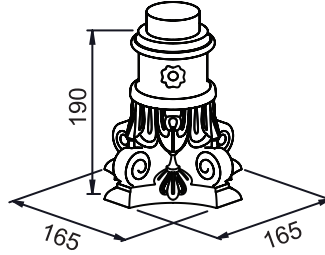

Temple

ref. : 60 TEMP B



Weight : 2,8 kg
 Structural element

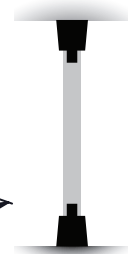
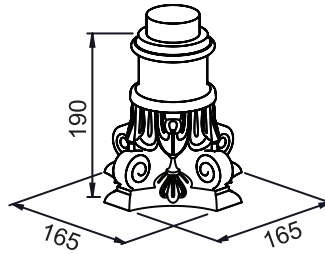

Tradition Royal

ref. : 60 TRADROY



Weight : 1,2 kg
 Non - structural element

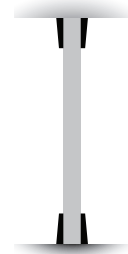
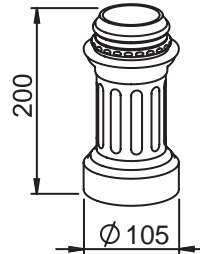

** All given dimensions on this page are in mm

DCC products - Columns Ø60

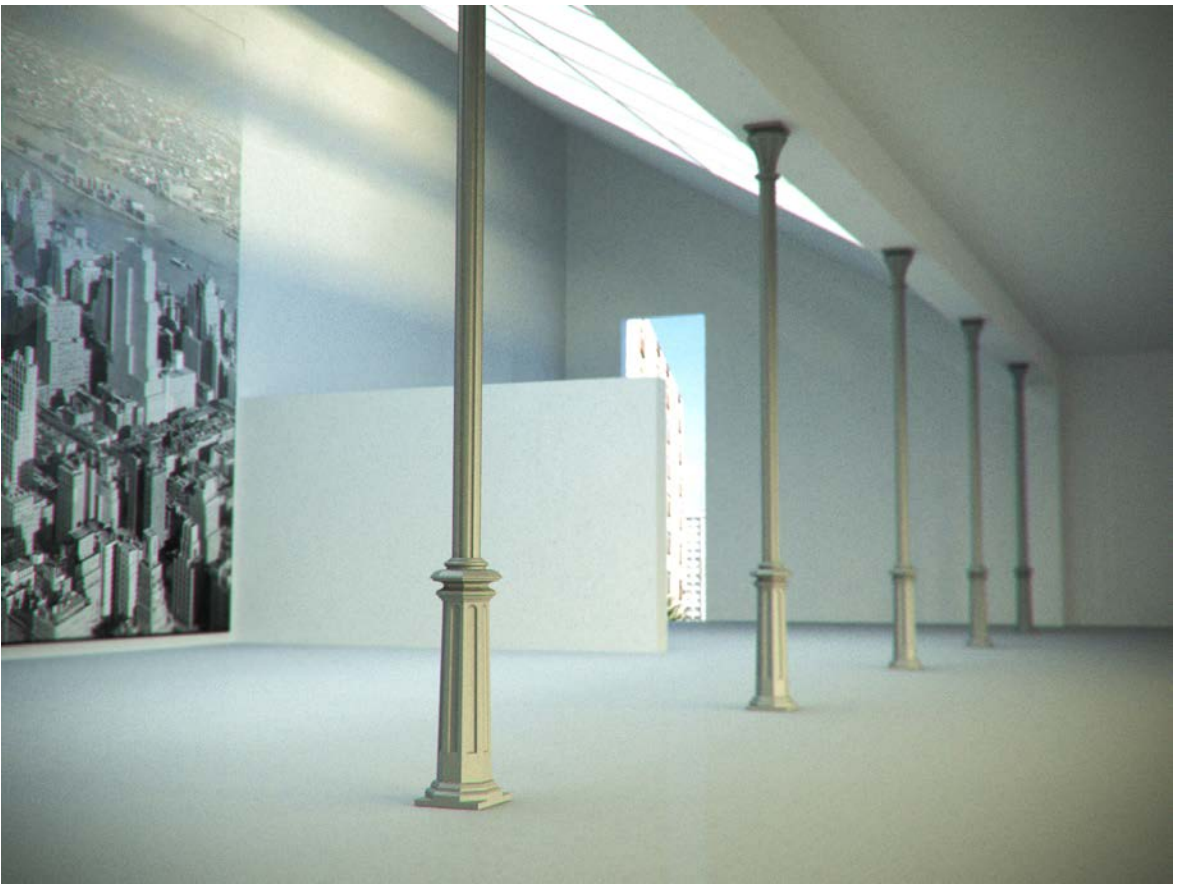

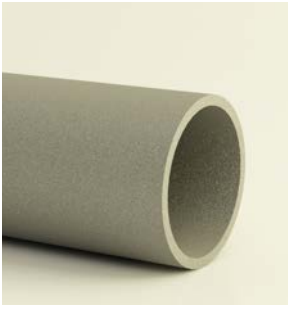

Shaft type '1'

ref. length 200cm* : **80 P1-2000**
 ref. length 250cm* : **80 P1-2500**
 ref. length 300cm* : **80 P1-3000**

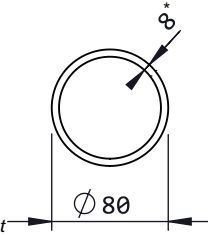

*Other sizes available on request
 *Section Ø80x10 available on request

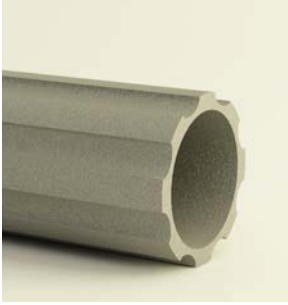

Shaft type '2'

ref. length 200cm* : **80 P2-2000**
 ref. length 250cm* : **80 P2-2500**
 ref. length 300cm* : **80 P2-3000**

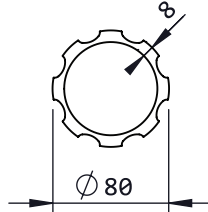

*Other sizes available on request



Deco type '1'

ref.: **80 DECO 1**

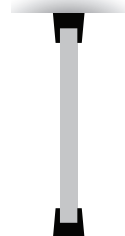
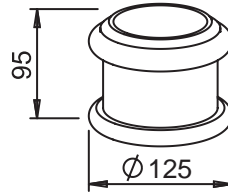

Weight : 1,3 kg
 Structural element



Deco type '2'

ref.: **80 DECO 2**

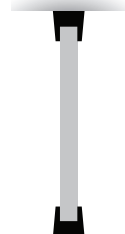
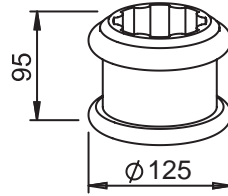

Weight : 1,3 kg
 Structural element



Fleur type '1'

ref.: **80 FLEUR 1**

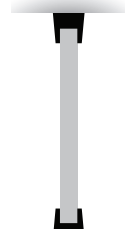
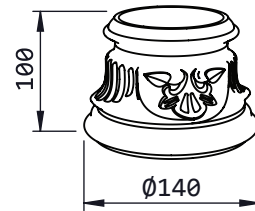

Weight : 1,2 kg
 Structural element



Fleur type '2'

ref.: **80 FLEUR 2**

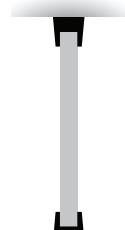
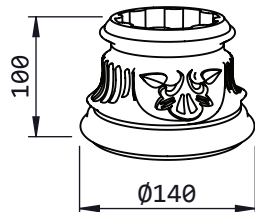

Weight : 1,2 kg
 Structural element

** All given dimensions on this page are in mm



Tulip

ref.: 80 TULIP



Weight : 1,3 kg
Structural element

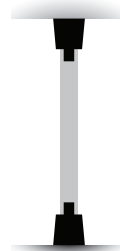
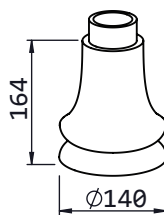

Temple Rosace

ref.: 80 TEMP A



Weight : 4,4 kg
Structural element

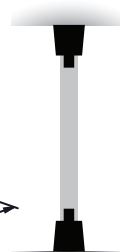
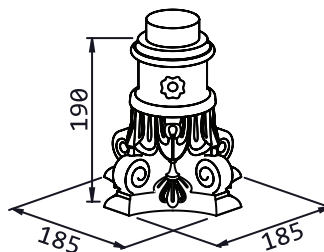

Temple

ref.: 80 TEMP B



Weight : 4,4 kg
Structural element

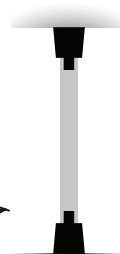
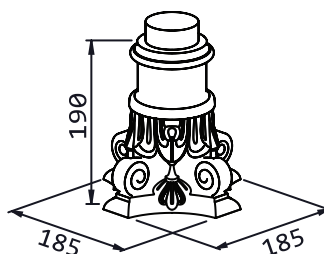



Square A

ref. : 80 SQUA A



Weight : 8,8 kg
Non - structural element

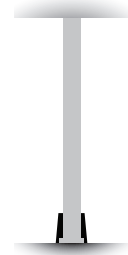
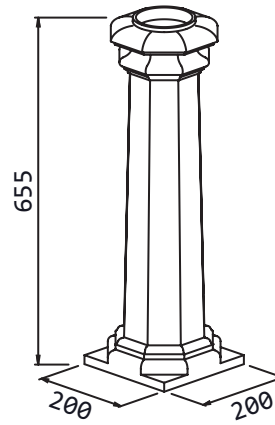

Square B

ref. : 80 SQUA B



Weight : 8,2 kg
Non - structural element

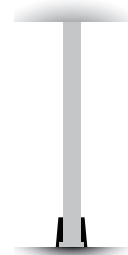
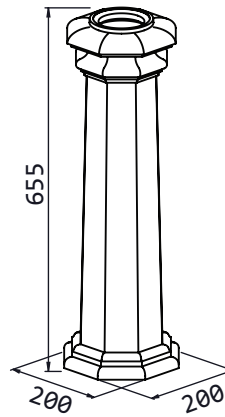

Square Royal A

ref. : 80 SQUAROY A



Weight : 9 kg
Non - structural element

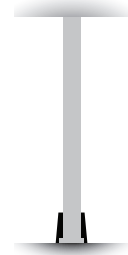
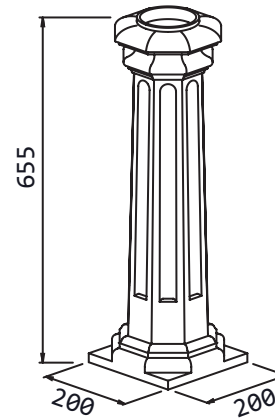

Square Royal B

ref. : 80 SQUAROY B



Weight : 7,2 kg
Non - structural element

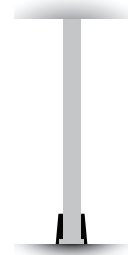
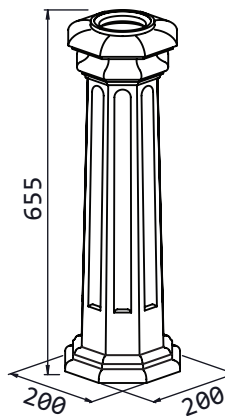

** All given dimensions on this page are in mm



Tradition A

ref.: 80 TRAD A



Weight : 5,7 kg
Non - structural element

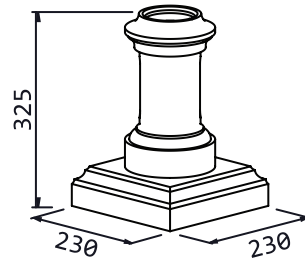

Tradition B

ref.: 80 TRAD B



Weight : 2,7 kg
Non - structural element

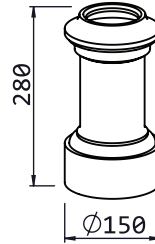

Tradition Royal A

ref.: 80 TRADROY A



Weight : 5,7 kg
Non - structural element

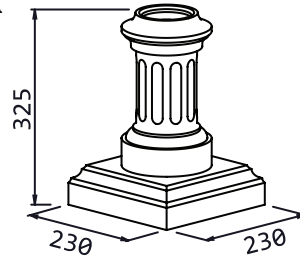

Tradition Royal B

ref.: 80 TRADROY B



Weight : 2,7 kg
Non - structural element

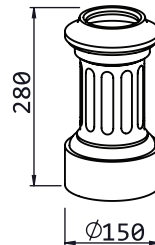

Trompette A

ref.: 80 TROMP A



Weight : 3,3 kg
Structural element

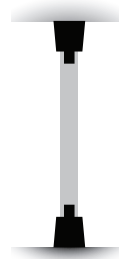
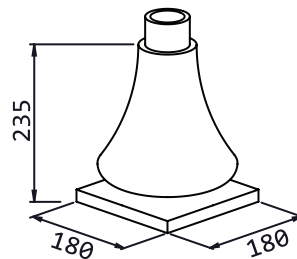

Trompette B

ref.: 80 TROMP B



Weight : 2,9 kg
Structural element

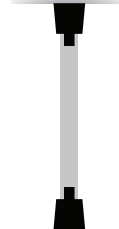
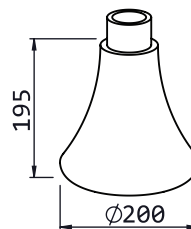

** All given dimensions on this page are in mm



Trompette Royal A

ref.: 80 TROMPROY A



Weight : 3,9 kg
Structural element

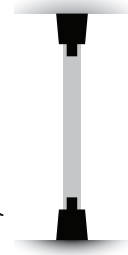
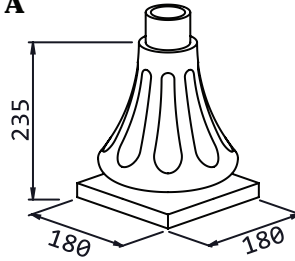

Trompette Royal B

ref.: 80 TROMPROY B



Weight : 2,9 kg
Structural element

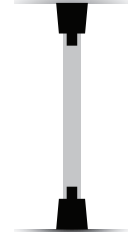
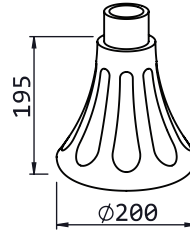

Opera A

ref.: 80 OPE A



Weight : 5,7 kg
Non - structural element

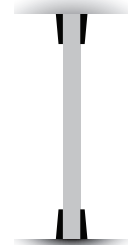
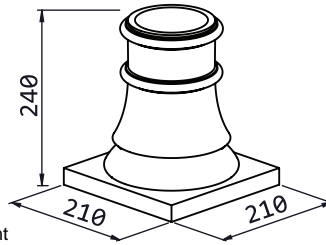

Opera B

ref.: 80 OPE B



Weight : 4,3 kg
Non - structural element

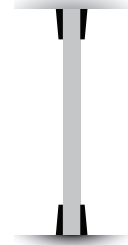
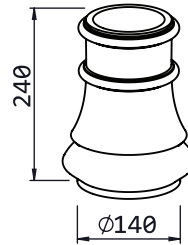

Tulip Large

ref.: 80 TULIP L



Weight : 1,3 kg
Non - structural element

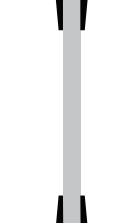
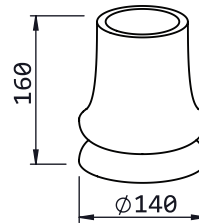

Omega

ref.: 80 OME



Weight : 1,2 kg
Non - structural element

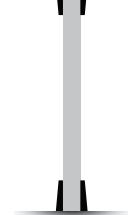
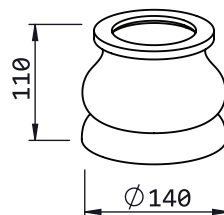

** All given dimensions on this page are in mm



Omega Max

ref.: 80 OME MAX



Weight : 1,4 kg
Non - structural element

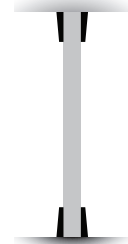
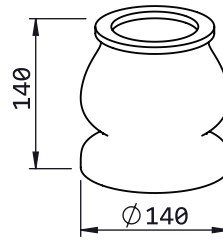

Rondo

ref.: 80 RONDO



Weight : 1,3 kg
Non - structural element

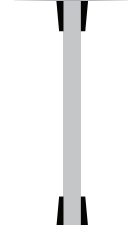
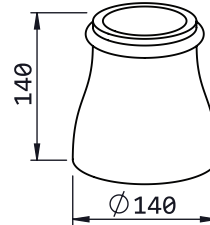

Ring Deco type '1'

ref.: 80 R DECO 1



Weight : 1,1 kg
Non - structural element

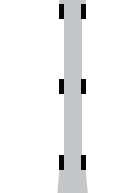
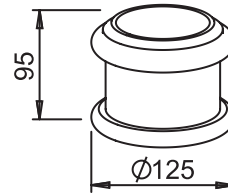

Ring Deco type '2'

ref.: 80 R DECO 2



Weight : 1,2 kg
Non - structural element

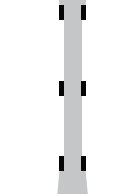
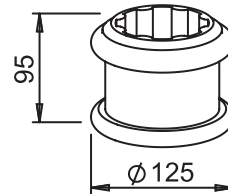

Ring Fleur type '1'

ref.: 80 R FLEUR 1



Weight : 1,1 kg
Non - structural element

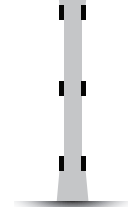
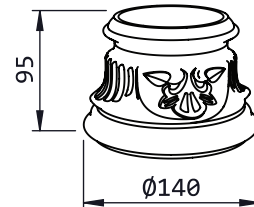

Ring Fleur type '2'

ref.: 80 R FLEUR 2



Weight : 1,2 kg
Non - structural element

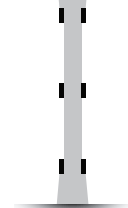
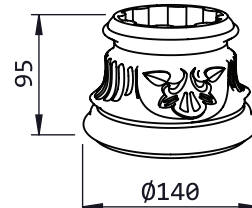

** All given dimensions on this page are in mm



Ring Architect type '1'

ref.: 80 R ARCHI 1



Weight : 0,3 kg
Non - structural element

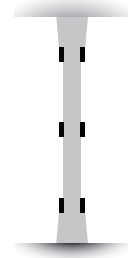
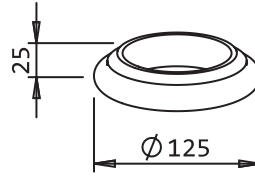

Ring Architect type '2'

ref.: 80 R ARCHI 2



Weight : 0,3 kg
Non - structural element

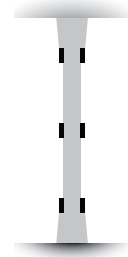
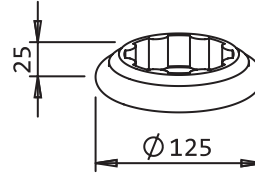

** All given dimensions on this page are in mm

DCC products - Columns Ø80



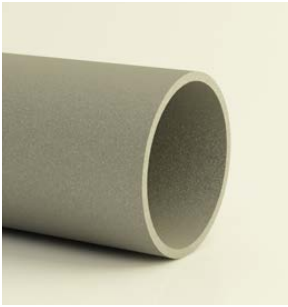

Shaft type '1'

ref. length 200cm* : 100 P1-2000
 ref. length 250cm* : 100 P1-2500
 ref. length 300cm* : 100 P1-3000
 ref. length 350cm* : 100 P1-3500



* Other sizes available on request
 * Section Ø100x10 available on request

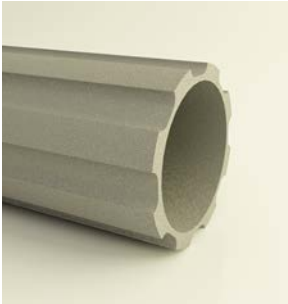
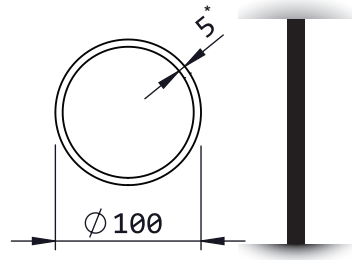

Shaft type '2'

ref. length 200cm* : 100 P2-2000
 ref. length 250cm* : 100 P2-2500
 ref. length 300cm* : 100 P2-3000
 ref. length 350cm* : 100 P2-3500



* Other sizes available on request

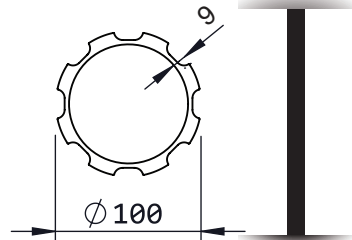

Deco type '1'

ref.: 100 DECO 1



Weight : 1,23 kg
 Structural element

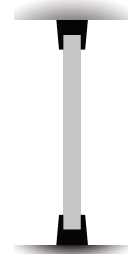
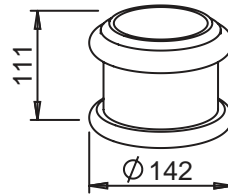

Deco type '2'

ref.: 100 DECO 2



Weight : 1,54 kg
 Structural element

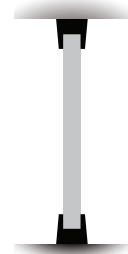
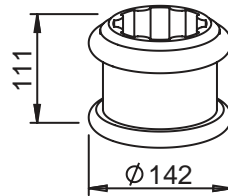

Trompette Royal A

ref.: 100 TROMPROY A



Weight : 6,85 kg
 Structural element

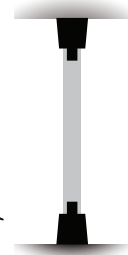
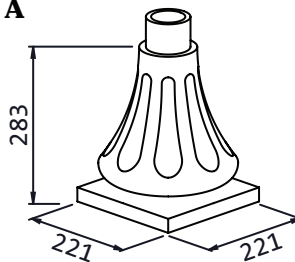

Trompette Royal B

ref.: 100 TROMPROY B



Weight : 4,4 kg
 Structural element

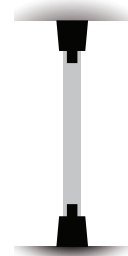
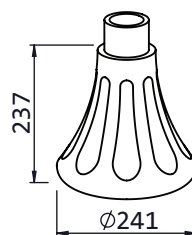

** All given dimensions on this page are in mm



Square A

ref. : 100 SQUA A



Weight : 8,8 kg
Non - structural element

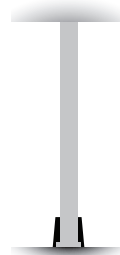
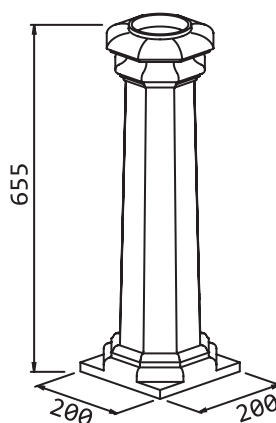

Square B

ref. : 100 SQUA B



Weight : 8,2 kg
Non - structural element

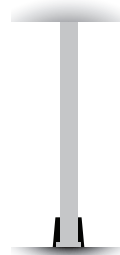
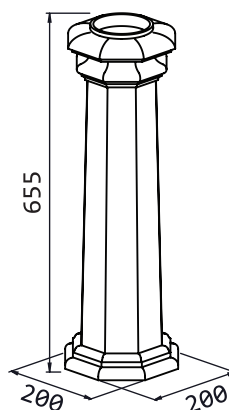

Square Royal A

ref. :

100 SQUAROY A

100 SQUAROY A 1055
(higher model : 1055mm)



Weight : 9 kg
Non - structural element

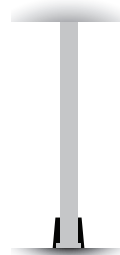
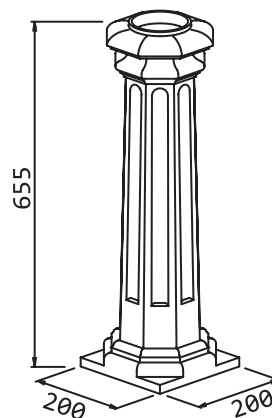

Square Royal B

ref. :

100 SQUAROY B

100 SQUAROY B 1055
(higher model : 1055mm)



Weight : 7,2 kg
Non - structural element

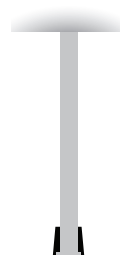
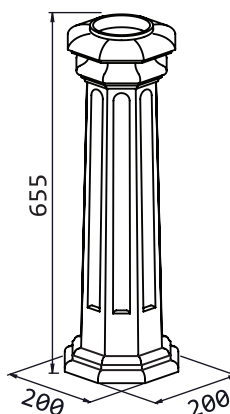



Opera A type '1'

ref.: 100 OPE A



Weight : 5,7 kg
Non - structural element

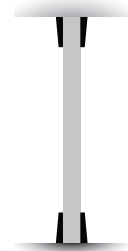
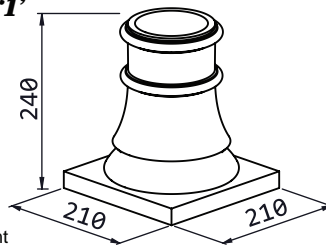

Opera A type '2'

ref.: 100 OPE A 2



Weight : 5,48 kg
Non - structural element

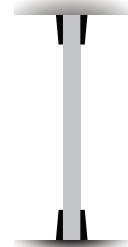
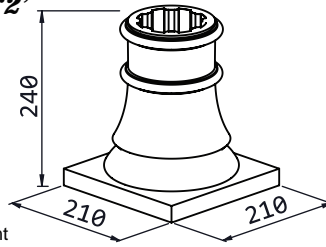

Opera B type '1'

ref.: 100 OPE B



Weight : 4,3 kg
Non - structural element

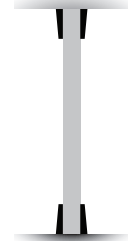
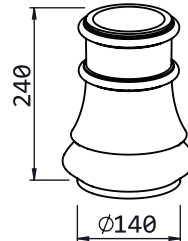

Opera B type '2'

ref.: 100 OPE B 2



Weight : 3,37 kg
Non - structural element

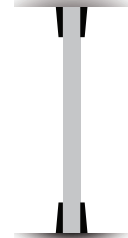
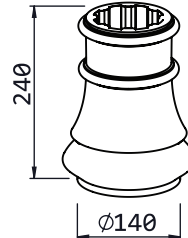

Tulip Large

ref.: 100 TULIP L



Weight : 1,3 kg
Structural element

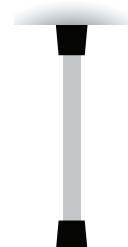
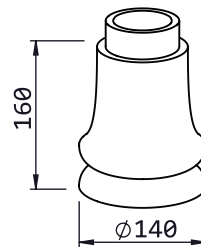

Omega

ref.: 100 OME



Weight : 1,2 kg
Structural element

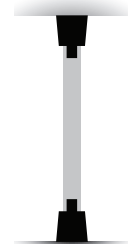
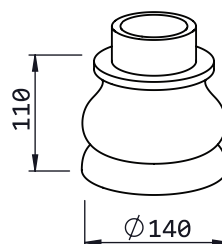

** All given dimensions on this page are in mm



Omega Max

ref.: 100 OME MAX



Weight : 2,6 kg
Structural element

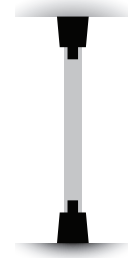
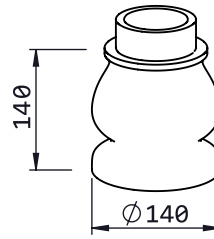

Ring Deco type '1'

ref.: 100 R DECO 1



Weight : 1,20 kg
Non - structural element

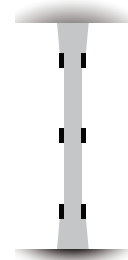
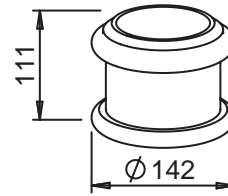

Ring Deco type '2'

ref.: 100 R DECO 2



Weight : 1,47 kg
Non - structural element

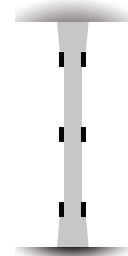
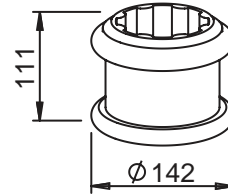

Ring Architect

ref.: 100 R ARCHI 1



Weight : 0,3 kg
Non - structural element

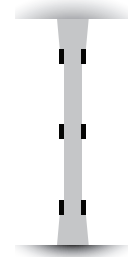
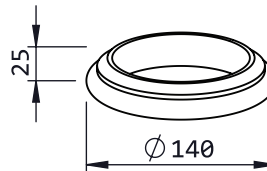

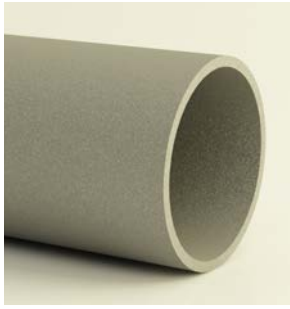

Shaft

ref. length 200cm : 140 P1-2000
 ref. length 250cm : 140 P1-2500
 ref. length 300cm : 140 P1-3000
 ref. length 350cm : 140 P1-3500

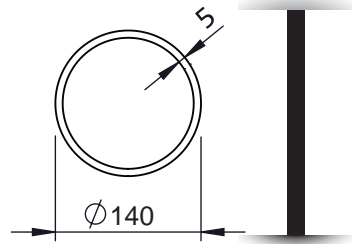

Deco type '1'

ref.: 140 DECO 1



Weight : 3,29 kg
 Structural element

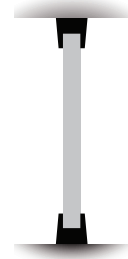
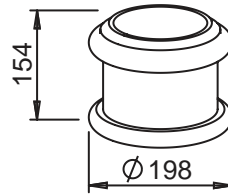

Ring Deco type '1'

ref.: 140 R DECO 1



Weight : 3,20 kg
 Non - structural element

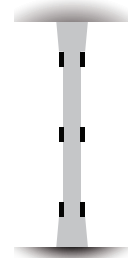
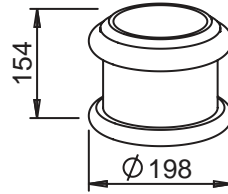

Opera B

ref.: 140 OPE B



Weight : 6,32 kg
 Non - structural element

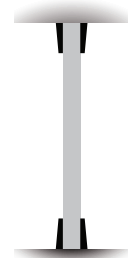
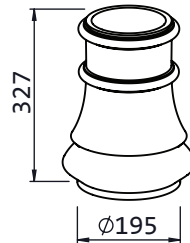

Opera A

ref.: 140 OPE A



Weight : 10,20 kg
 Non - structural element

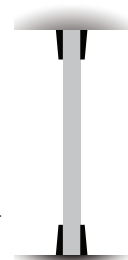
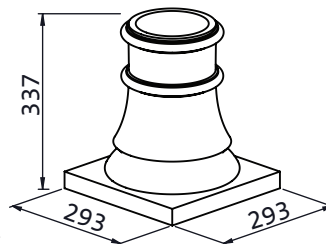

** All given dimensions on this page are in mm

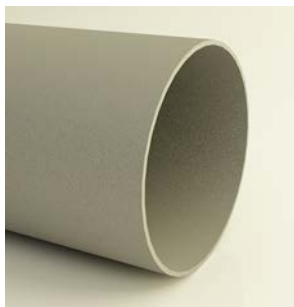

Shaft

ref. length 200cm : **200 P1-2000**
 ref. length 250cm : **200 P1-2500**
 ref. length 300cm : **200 P1-3000**
 ref. length 350cm : **200 P1-3500**

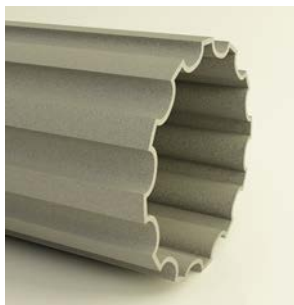
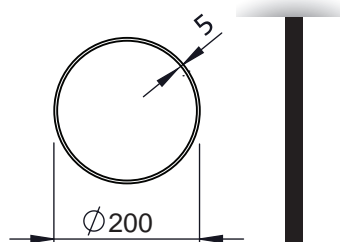

Shaft

ref. length 200cm : **200 P2-2000**
 ref. length 250cm : **200 P2-2500**
 ref. length 300cm : **200 P2-3000**
 ref. length 350cm : **200 P2-3500**

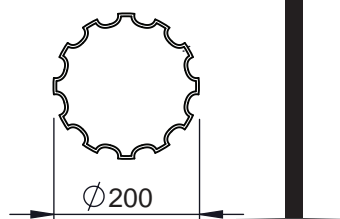

Dorique type '1'

ref.: **200 DOR 1**



Weight : 7,20 kg
 Non - structural element

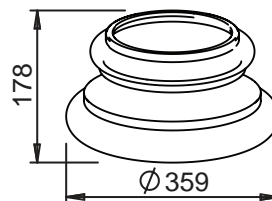

Dorique type '2'

ref.: **200 DOR 2**



Weight : 6,5 kg
 Non - structural element

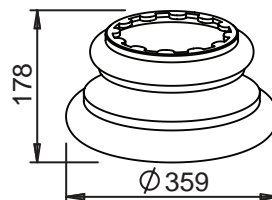

Roman type '1'

ref.: **200 ROM 1**



Weight : 7 kg
 Non - structural element

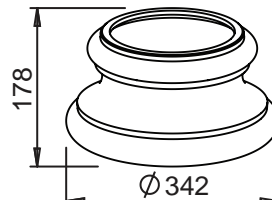

Roman type '2'

ref.: **200 ROM 2**



Weight : 7 kg
 Non - structural element

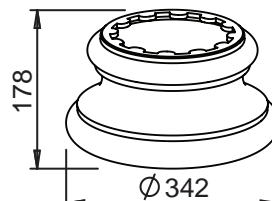

** All given dimensions on this page are in mm



Tuscan type '1'

ref.: 200 TUS 1



Weight : 4,6 kg
Non - structural element

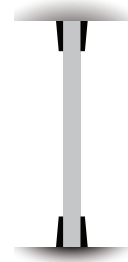
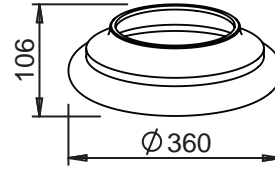

Tuscan type '2'

ref.: 200 TUS 2



Weight : 4,2 kg
Non - structural element

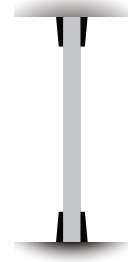
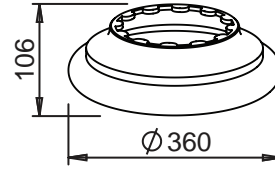



Frieze Gothique

ref.: VK 002

Dimensions : 455mm x 210mm x 40mm
Weight : 1000 gr



Spearhead Gothique

ref.: EP 002

Dimensions : 300mm x 133mm x 40mm
Weight: 600 gr



Frieze Fleur de Lys

ref.: VK 004

Dimensions : 500mm x 192mm x 45mm
Weight: 1900 gr



Spearhead Fleur De Lys

ref.: EP 004

Dimensions : 320mm x 100mm x 50mm
Weight: 1230 gr



Roofpeak Shogun

ref.: EP 005

Dimensions : 310mm x 117mm x 63mm
Weight: 670 gr



Roofpeak D'Artagnan

ref.: EP 006

Dimensions : 216mm x 59mm (bas : carré de côté 33mm)
Weight: 520 gr



Roofpeak Léonidas

ref.: EP 007

Dimensions : 215mm x 90mm (bas : Ø 16mm)
Weight: 190 gr



Roofpeak Fleur de Lys

ref.: EP 008

Dimensions : 190mm x 73mm (bas : Ø 15mm)
Weight: 116 gr



Rosette Huit-Feuilles

ref.: RO 001

Dimensions : Ø70mm - épaisseur 30mm
Weight: 50 gr



Rosette Fleur

ref.: RO 002

Dimensions : Ø47mm - épaisseur 7mm
Weight: 18 gr



Rosette Poppy

ref.: RO 003

Dimensions : Ø62mm - épaisseur 10mm
Weight: 40 gr



Rosette Six-Feuilles

ref.: RO 005

Dimensions : Ø71mm - épaisseur 9mm
Weight: 55 gr



Rosette Celtic

ref.: RO 006

Dimensions : Ø118mm - épaisseur 9mm
Weight: 160 gr



Rosette Marguerite

ref.: RO 008

Dimensions : Ø60mm - épaisseur 19mm
Weight: 127 gr



Rosette Nuages

ref.: RO 009

Dimensions : Ø90mm - épaisseur 18mm
Weight: 175 gr



Rosette Petite Fleur

ref.: RO 010

Dimensions : Ø47mm - épaisseur 6mm
Weight: 20 gr



Rosette Pâquerette

ref.: RO 014

Dimensions : Ø150mm - épaisseur 17mm
Weight: 365 gr



Rosette Maximus

ref.: RO 017

Dimensions : Ø245mm - épaisseur 60mm
Weight: 900 gr



Palmette / Ornement Fleur de Lys

ref.: RO 004

Dimensions : 77mm x 70mm x 8mm
Weight: 43 gr



Palmette / Ornement Flamme

ref.: RO 007

Dimensions : 109mm x 93mm x 20mm
Weight: 223 gr



Palmette / Ornement Aquarius

ref.: RO 011

Dimensions : 84mm x 46mm x 11mm
Weight: 40 gr



Palmette / Ornement Corbeille de Fruit

ref.: RO 012

Dimensions : 440mm x 90mm x 17mm
Weight: 195 gr



Palmette / Ornement Venus

ref.: RO 013

Note: Angle piece
Dimensions : 196mm x 114mm x 21mm
Weight: 258 gr



Palmette / Ornement Romantique

ref.: RO 015

Dimensions : 265mm x 97mm x 14mm
Weight: 85 gr



Palmette / Ornament Printemps

ref.: RO 016

Dimensions : 240mm x 345mm x 60mm
Weight: 2400 gr



Palmette / Ornament Losange

ref.: RO 018

Dimensions : 200mm x 105mm x 11mm
Weight: 106 gr



Palmette / Ornament Chevalier

ref.: RO 019

Dimensions : 293mm x 203mm x 34mm
Weight: 1100 gr



Palmette / Ornament Flabstract

ref.: RO 020

Dimensions : 295mm x 150mm x 10mm
Weight: 200 gr



Support Victoria Station

ref. : HS 01

Dimensions : 430mm x 275mm x 45mm
Weight: 3100 gr



Support Maximus

ref. : HS 02

Dimensions : 1180mm x 390mm x 70mm
Weight: 7400 gr



Support Elegance

ref. : HS 03

Dimensions : 430mm x 180mm x 50mm
Weight: 1700 gr

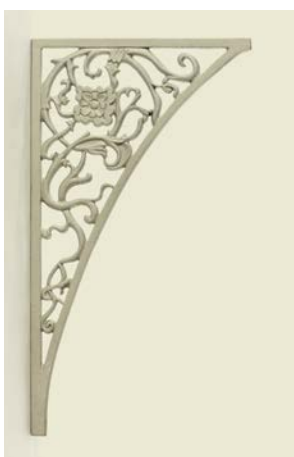

Angle piece Pergola

ref. : PER 001

Dimensions : 600mm x 330mm x 13mm
Weight: 1400 gr



Decorative rectangle Pergola

ref.: PER 002

Dimensions : 580mm x 330mm x 13mm
Weight: 3800 gr



Ring for tie rods Anémone

ref.: TR 001

Dimensions : 155mm x 120mm x 25mm
Weight: 800 gr



Decorative batten with cubic blocs

ref.: BL 001

Dimensions : 450mm x 30mm x 30mm
Weight: 630 gr



Horse head

ref.: PK 005

Dimensions : 256mm x 210mm (bas : Ø 160mm)
Weight: 4900 gr



"Quarter-rounds" for the outer corners of your veranda.

This new product of our aluminum foundry allows you to apply columns directly against the outside corners of a veranda, even with a non-overhanging roof.

The columns can be applied after construction works on the veranda have been done. It is a simple way to add some decorative touch to your realization, and that for a reasonable price.

Below You see our model ' trumpet A ' in a quarter-round version: ideal for usage with a slightly overhanging roof.

If the roof is not overhanging at all, you can use our model ' trumpet B ' (without the square base) in a quarter-round version to obtain a similar result.

Additionally, you can finish Your column with one of our decorative spheres in cast aluminum.

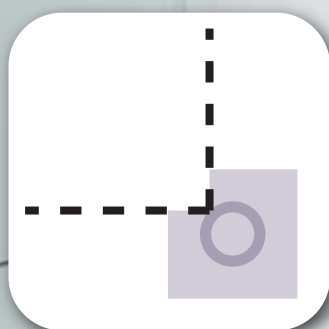



"Half-round" for the front or sides of your veranda.

This new product of our aluminum foundry allows you to apply columns directly against the pillars of a veranda, even with a non-overhanging roof.

The columns can be applied after construction works on the veranda have been done. It is a simple way to add some decorative touch to your realization, and that for a reasonable price.

Below You see our model ' trumpet A ' in a half-round version: ideal for usage with a slightly overhanging roof.

If the roof is not overhanging at all, you can use our model ' trumpet B ' (without the square base) in a half-round version to obtain a similar result.

Additionally, you can finish Your column with one of our decorative spheres in cast aluminum.

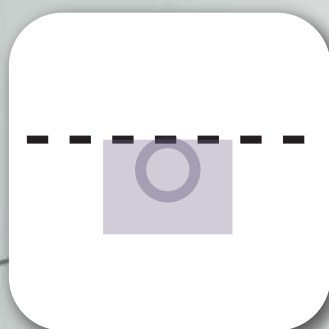

DC-Columns

(division of Aluminium Declercq nv/sa)

Vlaswaagplein 11
8501 Bissegem (Kortrijk)
Belgium

Tél. +32 56 714 114

sales@dc-columns-pillars.com

www.dc-columns-pillars.com

